

VECTOR OPTICS®

# FRENZY

RED DOT SIGHT USER MANUAL

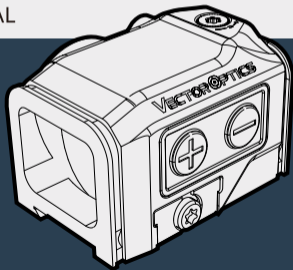

FRENZY PLUS

# ***READ IT BEFORE USE!!!***

READ AND UNDERSTAND THE CONTENTS OF YOUR FIREARM'S AND SCOPE MANUAL. FOLLOW ALL STANDARD SAFETY PRECAUTIONS AND PROCEDURES DURING FIREARM OPERATION.

▼ *Scan the QR code to learn more about VectorOptics*



VECTROPTICS



USER MANUAL



FACEBOOK



INSTAGRAM



*NEVER LOOK AT THE SUN THROUGH THE RED DOT SIGHT (OR ANY OTHER OPTICAL INSTRUMENT).  
IT MAY PERMANENTLY DAMAGE YOUR EYES.*

*MAKE SURE FIREARMS ARE UNLOADED AND POINTED IN THE SAFE DIRECTION.*

# CONTENTS

FOOTPRINT & MOUNTING .....	4
ZEROING .....	5
TURNING ON & ILLUMINATION ADJUSTMENT .....	6
BATTERY EXCHANGE .....	8
MAINTENANCE .....	9
STORAGE .....	10
RETICLE .....	11
WARRANTY .....	12
NOTES .....	14

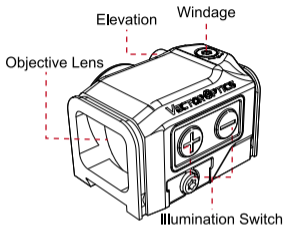

## V<sup>o</sup>™ Red Dot Footprint

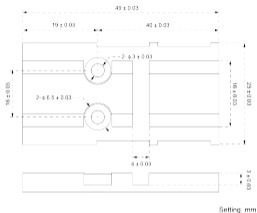

## MOUNTING

The red dot scope is intended for use on pistol slides. It adopts an industry-standard mounting interface and is compatible with the footprint that meets the criteria shown above. The red dot scope can also accept a picatinny or dovetail mount with a compatible footprint.

## ZEROING

The sight features elevation and windage adjustments. Referring to the point of impact you will need to adjust both windage and elevation screws. The elevation is the vertical (up and down) adjustment, usually on the top of the sight. Windage is the horizontal (left-to-right) adjustment, usually on the right of the sight. With the sight is mounted aim at a target 50/100 yards away. Slowly shoot a small 3 to 5 round test group onto your target. Adjust windage & elevation screws in the direction you want to move the bullet impact. Should your impacts be below your point of aim, dial UP to reach zero.

## **TURNING ON & ILLUMINATION ADJUSTMENT**

The sight is activated by using the digital on/off switch placed on the left of the sight. The sight has 9 levels of visible dot & 2 NV dots.

**SCRD-75:** Press and hold the '+' or '-' switch for 1 second to turn the unit on. Subsequently press the '+' will increase the dot intensity. Press the '-' switch will decrease the dot intensity. Press and hold the '-' switch for more than 3 seconds to turn the sight off.

**SCRD-63:** Press and hold the '+' switch for 1 second to turn the unit on. Subsequently press the switch will increase the dot intensity. Press the '-' switch will decrease the dot intensity. Press and hold the '-' switch for more than 3 seconds to turn the sight off.

Motion Sensor illumination (MOS) : If the scope comes with this feature, it will power off when it is at rest after 3 minutes and power on when it senses any motion.

Solar Power Engaged: If the scope comes with this feature, It allows the red dot scope to continue to power on when the battery fails. You can still manually control the dot intensity by pressing the '+' or '-' switch.

## BATTERY EXCHANGE

The red dot scope is powered by 1 piece of the CR2032 button battery. Should the dot grows dim or not turn on, you will need to exchange the battery. Release the battery compartment cover. Remove the used battery from the battery compartment. Insert a new one from a reputable manufacturer with the positive (+) side UP. Screw on the battery compartment cover.

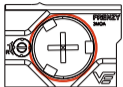

SCRD-63



SCRD-75

### WARNING

- **INGESTION HAZARD:** This product contains a button cell or coin battery.
- **DEATH;** or serious injury can occur if ingested.
- A swallowed button cell or coin battery can cause internal chemical burns in as little as 2 hours.
- Keep new and used batteries out of reach of children.
- Seek immediate medical attention if a battery is suspected to be swallowed or inserted inside any part of the body.
- Battery misuse or abuse may result in leakage, fire or explosion.





## MAINTENANCE

Your red dot sight, though amazingly tough, is a precision instrument that deserves reasonable cautious care.

- When cleaning the lens, first blow away any dirt and dust, or use a soft lens brush. Fingerprints and lubricants can be wiped off with lens tissue, or soft cleancotton cloth, moistened with lens cleaning fluid.
- All moving parts of the red dot sight are permanently lubricated. Do not try to lubricate them.
- No maintenance is needed on the red dot sight's outer surface, except to occasion- ally wipe off dirt or fingerprints with a soft cloth.
- Use lens covers whenever convenient.

## **STORAGE**

Avoid storing the red dot sight in hot places, such as the passenger compartments of vehicles on hot days. The high temperatures could adversely affect the lubricants and sealants. A vehicle's trunk, a gun cabinet, or a closet is preferable. Never leave the red dot sight where direct sunlight can enter either the objective lens. Damage may result from the concentration (burning glass effect) of the sun's rays.

## RETICLE PATTERN

Multi Reticle (If applicable)

PRESS THE + BUTTON FOR MORE THAN 3 SECONDS TO SWITCH THE RETICLE.



Circle + Crosshair Dot



Crosshair Circle



Standard Dot

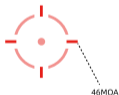

46MOA



38MOA



3MOA

FOR MORE DETAILS PLEASE SCAN QR CODE OR VISIT THE LINK :

<https://youtu.be/idii2atdv9Q>



## **VECTOR OPTICS TAILED VIP LIFETIME WARRANTY**

Your VectorOptics Continental, Taurus, Paragon, Scrapper, and Frenzy line products are covered by our T-VIP lifetime warranty. We will, at our option, either repair or replace your VectorOptics product without any cost if it is damaged or defective. If we can't repair your damaged product, we will replace it with a brand new one in perfect condition. We proudly stand behind our products. You have our word that we will do what it takes to retain your business as a satisfied customer. You can count on our T-VIP lifetime warranty.

- Unlimited full lifetime warranty.
- Reply to you in 1 working day.
- Free repair or replacement.
- Fully transferable.
- No invoice or receipt is needed.
- No question asked, however, we do appreciate your feedback.
- We pay for shipping back to you.

This warranty does not cover product loss, theft, deliberate damage, abuse, misapplication, or modification. This warranty does not apply to electronic components or batteries.

For warranty service please contact our Customer Service Department online at [service@vectoroptics.com](mailto:service@vectoroptics.com) for return instructions. If you need to return the product, please ensure the shipment and keep the tracking records. We can not be responsible for your product until it has been received by our Customer Service Department. For products not directly purchased from us, please contact the local dealer for applicable warranty info.

Any warranty must be registered and complete warranty terms by the link:

[warranty.vectoroptics.com](http://warranty.vectoroptics.com)

We thank you for your business. Be Safe and Have Fun!



## NOTES

---

---

---

---

---

---

---

---

---

---

## NOTES

---

---

---

---

---

---

---

---

---

---

---

# FRENZY

## RED DOT SIGHT

Manual # Frenzy Series

2024111101



🌐: [www.vectoroptics.com](http://www.vectoroptics.com)

@vector\_optics